



Model 802 Scintillation Detectors

Features

- Guaranteed resolution
- Low mass housing
- Less than 0.5 ppm of potassium
- Mu metal magnetic light shield

Description

The Model 802 Scintillation Detector is a hermetically sealed assembly which includes a high resolution NaI(Tl) crystal, a photomultiplier tube, an internal magnetic/light shield, an aluminum housing, and a 14-pin connector.

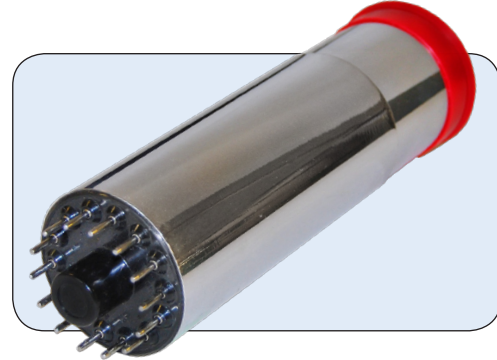

The 802 series of NaI(Tl) detectors provides high efficiency and uniform response on both the cylindrical and well configurations. These detectors have a proven record of long term reliability and stability.

Any Model 802 assembly plugs directly into the Model 2007 Tube Base which provides power for the photomultiplier tube. Alternatively, the Model 802 can plug into the Model 2007P combination tube base and preamplifier.

Many crystal sizes are available, with the most common sizes listed below. Consult the factory for information on other sizes.

Model	Crystal Size mm (in.)	Resolution*	Outline Drawing	Well Dimensions mm (in.)	
				D	L
802-2x.5	51 x 13 (2 x .5)	15%	A	N.A.	N.A.
802-2x2	51 x 51 (2 x 2)	8.5%	A	N.A.	N.A.
802-2x2W	51 x 51 (2 x 2)	9.0%	B	16.66 (0.656)	39.27 (1.546)
802-3x3	76 x 76 (3 x 3)	7.5%	C	N.A.	N.A.
802-3x3W	76 x 76 (3 x 3)	9.0%	C	16.66 (0.656)	54.40 (2.063)

*Resolution is specified at the 662 keV peak of ¹³⁷Cs except for 802-2 x .5 which is specified at 122 keV.

Specifications and options listed on back.

Phone contact information

Benelux/Denmark (32) 2 481 85 30 • Canada 905-660-5373 • Central Europe +43 (0)2230 37000 • France (33) 1 39 48 52 00 • Germany (49) 6142 73820
 Japan 81-3-3500-5808 • Russia (7-495) 429-6577 • Sweden +46 18 14 83 00 • United Kingdom (44) 1235 838333 • United States (1) 203-238-2351

For other international representative offices, visit our web site: www.canberra.com or contact the CANBERRA U.S.A. office.

CSP0232 2/09 Printed in U.S.A.

Model 802 Scintillation Detectors

Specifications

- WINDOW – Aluminum, 0.5 mm thick; density 147 mg/cm².
- REFLECTOR – Oxide; 1.6 mm thick; density 88 mg/cm².
- MAGNETIC/LIGHT SHIELD – Conetic lined steel.
- TYPICAL OPERATING VOLTAGES:
 - Cathode to Anode +1100 V dc.
 - Dynode to Dynode +80 V dc.
 - Cathode to Dynode +150 V dc.

OPTIONS

- Model 2007 Tube Base with voltage divider and focus control.
- Model 2007P Tube Base with voltage divider, focus control, and preamplifier.

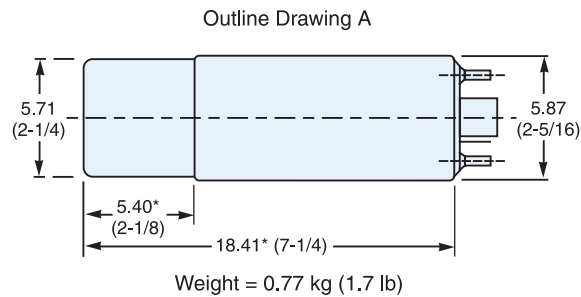

*Deduct 3.8 (1.5) for 802-2 x .5

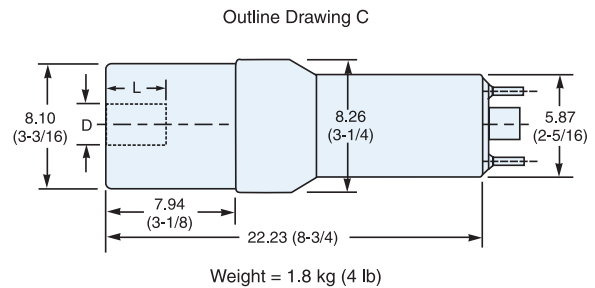
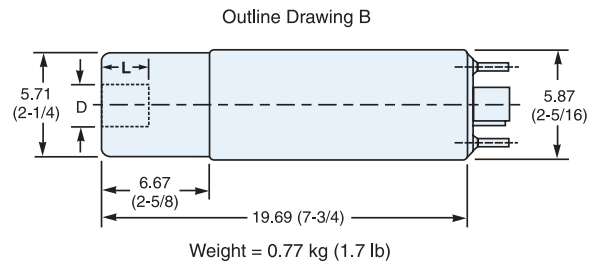

Dimensions in the Outline Drawings are in cm (in.)

